



Rex Road Elementary School (E-52)

Schematic Design Presentation to Facilities Committee

Mark Strickland, Douglas Congdon, Elizabeth Sharpe + Shane Webster and Alice Reese
January 19, 2022

E-52 Elementary School – Project Goals + Drivers

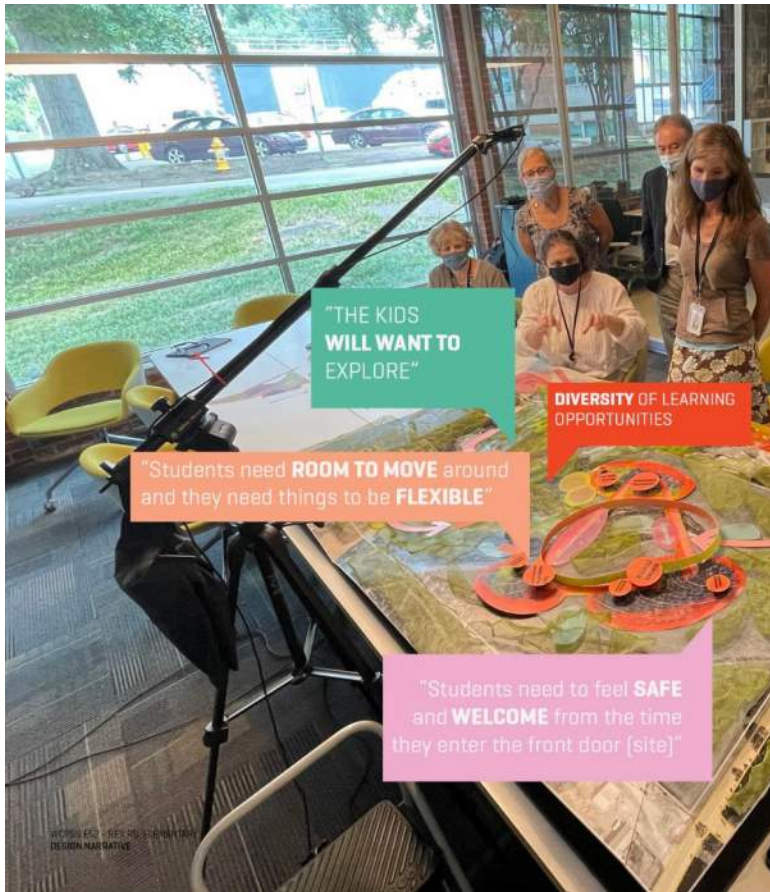

* *Meet Program Goals*

- * An educational environment that ***extends beyond the walls*** of the building
- * ***Intuitive + integrated opportunities*** for indoor and outdoor learning
- * Encourage ***exploration + discovery***
- * ***Encourage community*** among students and teachers while providing ***INDIVIDUAL OPPORTUNITIES*** for learning based on each student's needs
- * Adaptable + ***flexible*** - 'design for the changing 'universe'
- * ***Maximize utilization*** of space + site; reinterpret the constraints
- * ***Safe and welcoming***
- * Simple, yet impactful, ***sustainability***
- * Introduce new ideas + ***change for the future!!***

VINES

E-52 Elementary School – Location



E-52 Elementary School – Existing Site



SITE INTRODUCTION

- 40.8 Acre site along Rex Road in the Town of Holly Springs
- Extensive topography and mature vegetation
- New residential development under construction adjacent to the site's northern boundary
- Environmental features:
 - Multiple streams bisect the site and require buffers
 - Wetland areas
 - Topography and Streams impact the buildable area

E-52 Elementary School – Concept Exploration

OPTION 1: ASSEMBLE

The ASSEMBLE concept organized the school into four smaller buildings with a central courtyard. The design of the building was inspired by the traditional courtyard school design, which is a common design in many parts of the world.



OPTION 2: REACH

The REACH concept is a series of four buildings that reach out to the site from the north and south. The design is inspired by the traditional courtyard school design, which is a common design in many parts of the world.



OPTION 3: ENCIRCLE

The ENCIRCLE concept is a series of four buildings that encircle the site. The design is inspired by the traditional courtyard school design, which is a common design in many parts of the world.



OPTION 4: EMBRACE

The EMBRACE concept is a series of four buildings that embrace the site. The design is inspired by the traditional courtyard school design, which is a common design in many parts of the world.



E-52 Elementary School – Site Plan



- 1 Pre-K Play Area - 3,200 sqft
- 2 Pre-K Play Equipment Area - 35 x 40'
- 3 Adaptive Curriculum Play Area - 1,000 sqft
- 4 K-2 Paved Play - 56 x 60'
- 5 K-2 Playground Equipment
- 6 K-2 Open Play
- 7 3-5 Open Play
- 8 3-5 Paved Play
- 9 3-5 Playground Equipment
- 1 The Wetland Lab
- 2 The Play Commons (Outdoor Classroom)
- 3 Outdoor Classroom
- 4 Access to 3-5 Play Area
- 5 The Forest Ramble (Greenway Connection)
- 6 Pedestrian Bridge
- 7 Main Entrance
- 8 Dining Patio
- 9 The Greeting Garden
- D1 Bus Drop-off
- D2 Car Drop-off
- S Stormwater Management Area
- SY Service Yard
- P1 Main Parking - 80 Spaces
- P2 Visitor Parking - 14 Spaces
- P3 Bus Parking - 28 Spaces
- PS Sewer Pump Station
- MC Mobile Classroom Zone - 4 Classrooms

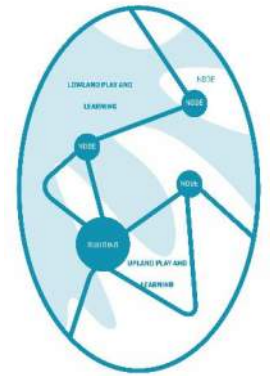

E-52 Elementary School – Floor Plans

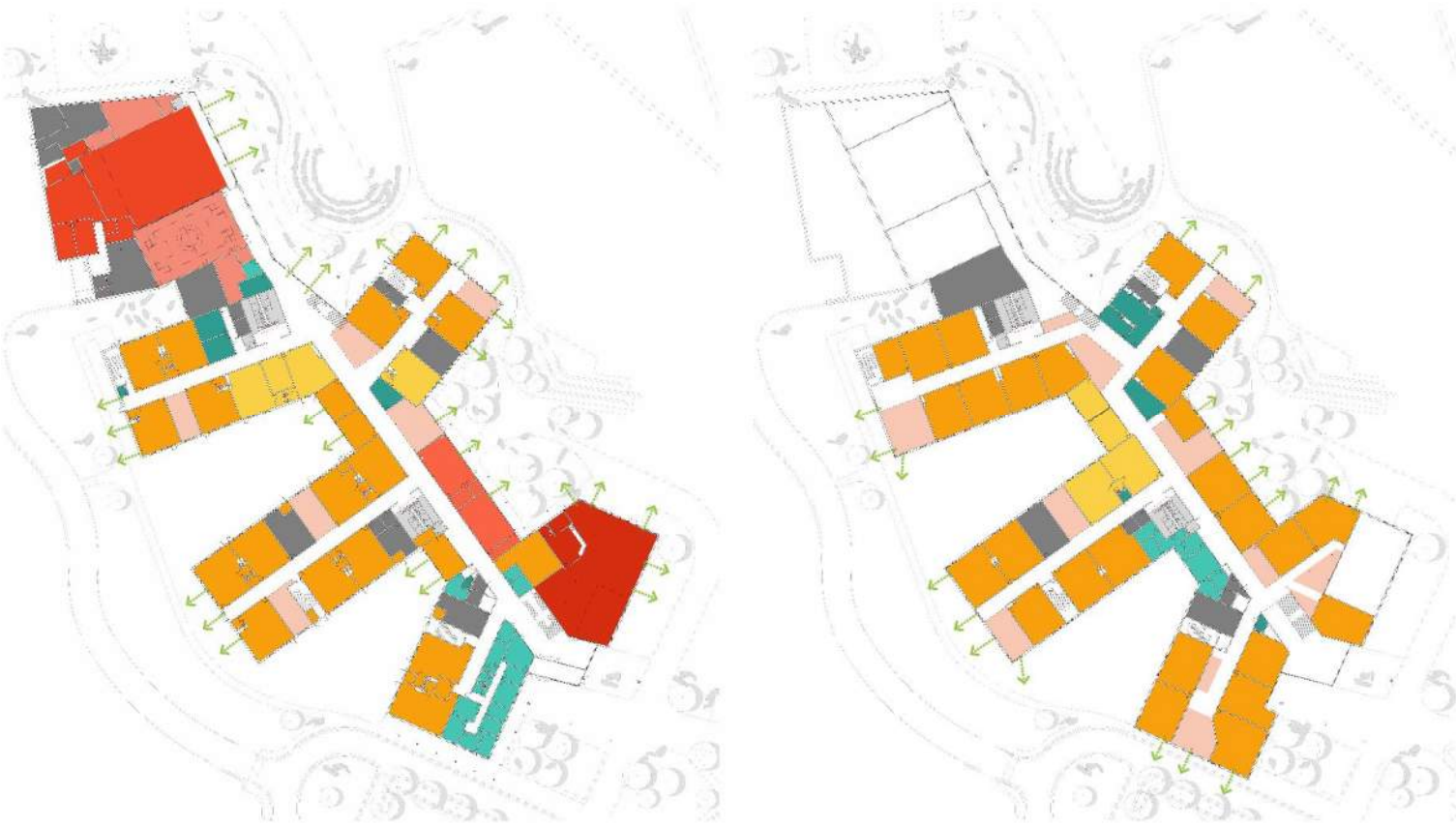

- Classrooms, Pre-K, and Gen Ed.
- Special Education
- Learning Commons
- Media Center
- Child Nutrition
- Visual Arts + Music
- Health + PE
- Administrative
- Staff Requirements
- Student Support Services
- Plant Operations, MEP, and Egress Stairs



E-52 Elementary School – Entry and Axon



E-52 Elementary School – Interior Lobby



E-52 Elementary School – Cafeteria and Classroom Wing

